

超小型钮子开关 Sub-Miniature Toggle Switch

技术特性 Specifications

1. 规格 Rating: 3A 125VAC; 1.5A 250VAC
2. 接触电阻 Contact Resistance: 20mΩ max
3. 绝缘电阻 Insulation Resistance: 500VDC 1000MΩ min
4. 耐电压 Dielectric Strength: 1000VAC, 1 Minute
5. 操作温度 Operating Temperature: -25°C~ +85°C
6. 电气寿命 Electrical Life: ≥10,000 Cycles

选型说明 How to order

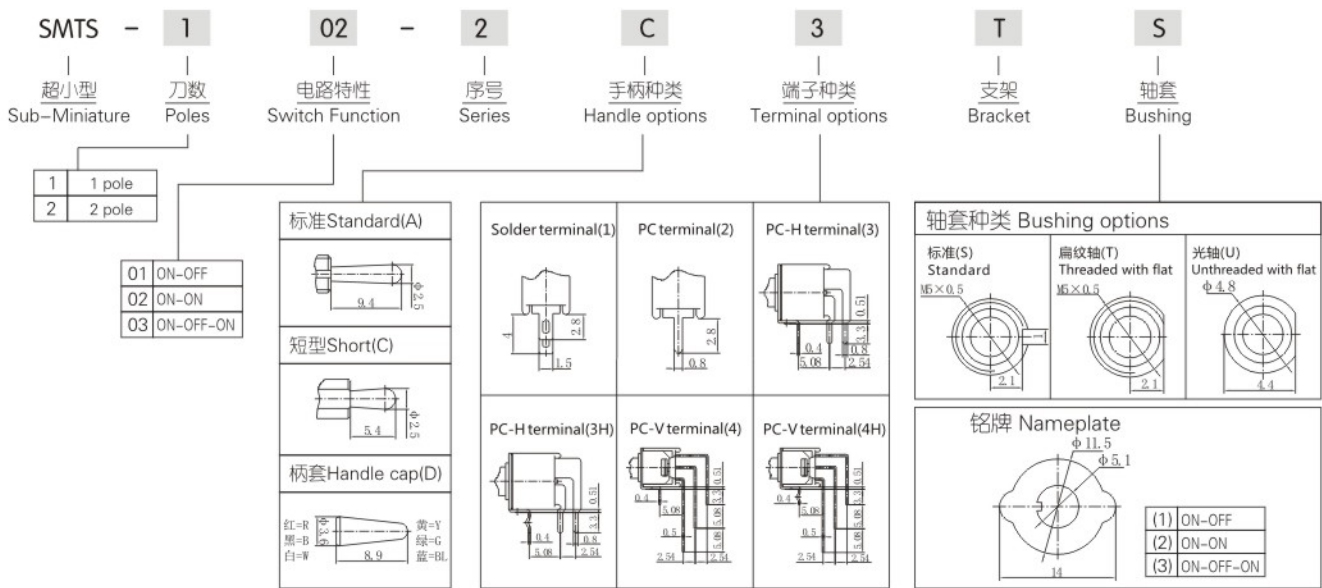

外形尺寸 Dimension



SMTS-101 ON-OFF
SPST 2P

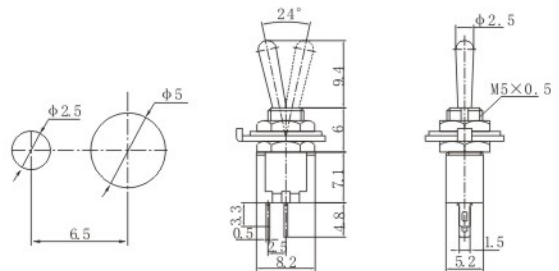

SMTS-102 ON-ON
SPDT 3P

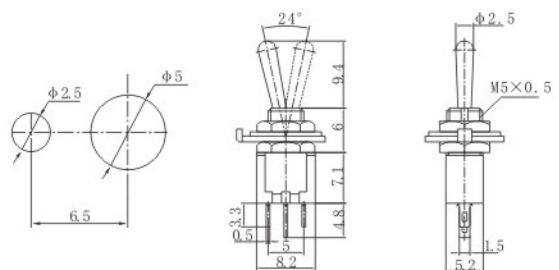



SMTS-202 ON-ON
DPDT 6P

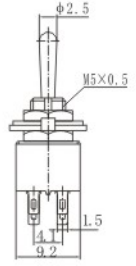
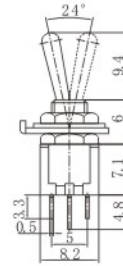
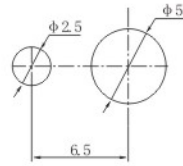

SMTS-102-A2 ON-ON
SPDT 3P

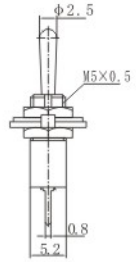
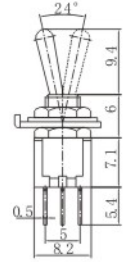
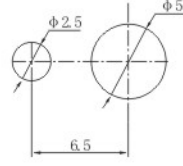

SMTS-202-A2 ON-ON
DPDT 6P

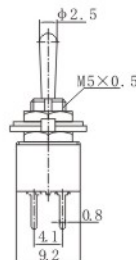
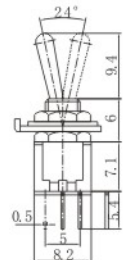
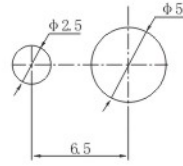

SMTS-103-2A1 ON-OFF-ON
SPDT 3P

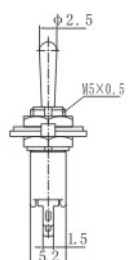
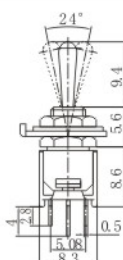
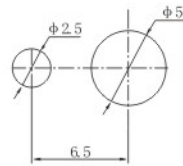

SMTS-203-2A1 ON-OFF-ON
DPDT 6P

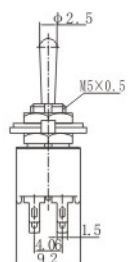
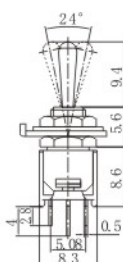
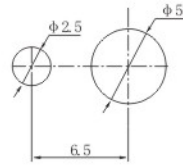

SMTS-102-2C3 ON-ON
SMTS-103-2C3 ON-OFF-ON
SPDT 3P

