



## SPECIFICATION FOR APPROVAL

CUSTOMER: platan

EVERCOOL MODEL NO: EC9225HH12B

CUSTOMER MODEL NO: EC9225HH12B

DESCRIPTION: DC12V FAN

|                                     |                 |
|-------------------------------------|-----------------|
| <b>APPROVED BY<br/>(AUTHORISED)</b> | <b>APPROVED</b> |
|                                     | <b>Alex</b>     |
|                                     | <b>CHECKED</b>  |
|                                     | <b>Xiongwei</b> |
|                                     | <b>DRAWN</b>    |
|                                     | <b>Chenjie</b>  |
|                                     | <b>SALES</b>    |
|                                     | <b>Serene</b>   |

\* Please confirm your acceptance by return fax or mail.

| SPEC NO     | ISSUE DATE | EDITION | REVISED DATE |
|-------------|------------|---------|--------------|
| 20230324A03 | 2023/3/24  | A0      | 2023/3/24    |

THE PRODUCTION ACCORD WITH EUROPE UNION ROHS STANDARD

**EVERCOOL THERMAL CO., LTD**

NO. 123-8, HSING DE RD., SAN-CHUNG CITY,  
TAIPEI HSIEN, TAIWAN, R.O.C.

TEL: 886-2-8512-2889 FAX: 886-2-8512-2890

[URL:www.evercool.com.tw](http://www.evercool.com.tw)

[EMAIL: coolest@ms14.hinet.net](mailto:coolest@ms14.hinet.net)

## I. GENERAL SPECIFICATION

| Item                       | Specification      |
|----------------------------|--------------------|
| 1.Part NO.                 | EC9225HH12B        |
| 2.Outline Dimension        | 92*92*25           |
| 3.Rated Voltage            | 12 VDC             |
| 4.Starting Voltage         | 7 VDC              |
| 5.Operating Voltage Range  | 7 VDC~ 13.8 VDC    |
| 6.Rated Current*           | 0.3 A              |
| 7.Rated Power Consumption* | 3.6 W              |
| 8.Rated Speed*             | 3000 RPM±15%       |
| 9.Max. Airflow**           | 61.11 CFM(ft3/min) |
| 10.Max. Static Pressure**  | 0.14 In-H2O        |
| 11.Noise Level***          | <28.1 dB(A)        |
| 12.Life Expectancy         | 50000 hrs at 25°C  |
| 13.No of Polarity          | 4 Poles            |
| 14.Direction of Rotation   | Counter-Clockwise  |

### Noted:

#### \*Input Current Speed Power Consumption

Measured after continuous 30 minutes operation at rated voltage in free air at ambient temperature of 25 °C, 65% relative humidity

#### \*\*Performance

Measured with use of double chamber. The value are recorded when the fan speed is stabilized at rated voltage.

#### \*\*\*Noise Level

Measured at rated voltage in a semi-anechoic chamber with background noise below than 20 dB(A). The measuring distance is in one meter from microphone to inlet of the fan.

## II. ELECTRICAL SPECIFICATION

| Item                    |       | Specification   |
|-------------------------|-------|---|
| 1.Polarity Protection   | ✓ YES | Be capable of endurance when Vcc & GRD are exchanged    |
|                         | NO    |   |
| 2.Auto restart          | ✓ YES | Locked motor protection                                 |
|                         | NO    |   |
| 3.Insulation Resistance |       | 10MΩ/b/w unshielded wire and frame at 500 VDC/min       |
| 4.Dielectric Strength   |       | 5Ma Max./Measured b/w lead wire and frame at 500VAC/min |

## III. MAIN MATERIALS / PARTS SPECIFICATION

| Item                     |   | Specification                     |     |      |    |     |
|--------------------------|---|-----------------------------------|-----|------|----|-----|
| 1.Materials of Frame     |   | Thermoplastic PBT of UL 94V-0(BK) |     |      |    |     |
| 2.Materials of Fan Blade |   |                                   |     |      |    |     |
| 3.Bobbin                 |   |                                   |     |      |    |     |
| 4.Bearing                | ✓ | Dual ball bearing                 |     |      |    |     |
|                          |   | 1 ball & 1 sleeve bearing         |     |      |    |     |
|                          |   | Sleeve bearing                    |     |      |    |     |
|                          |   | EL bearing                        |     |      |    |     |
| 5.Lead wire              | ✓ | Red (+)                           | UL# | 1007 | 26 | AWG |
|                          | ✓ | Black (-)                         | UL# | 1007 | 26 | AWG |
|                          |   |                                   |     | ---  |    |     |
|                          |   |                                   |     | ---  |    |     |
| 6.Connector              |   | 2510 2P                           |     |      |    |     |

## IV. ENVIRONMENT SPECIFICATION

| Item                    | Specification   |
|-------------------------|---|
| 1.Operation Temperature | -10°C~+70°C/66%(RH), high / low temperature test for 24 hours, temperature change: 30°C /hours. |
| 2.Storage Temperature   | -40°C~+70°C/66%(RH), high / low temperature test for 24 hours, temperature change: 30°C /hours. |

## V. DROPPING TEST

Prepared in minimum packing condition, fan will withstand one drop each on three surfaces from 30 cm height onto a 10mm thick hard wooden board.

## VI. LABEL MARKING

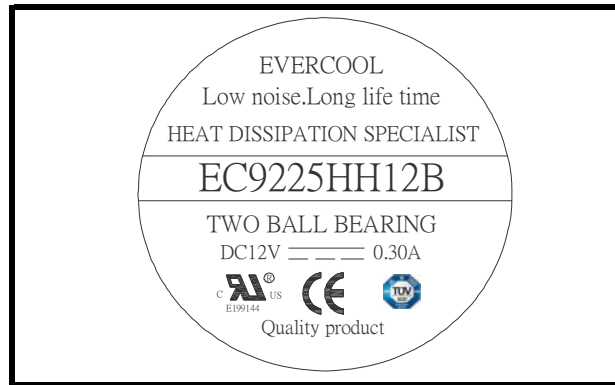

## VII. OUTLINE DIMENSION

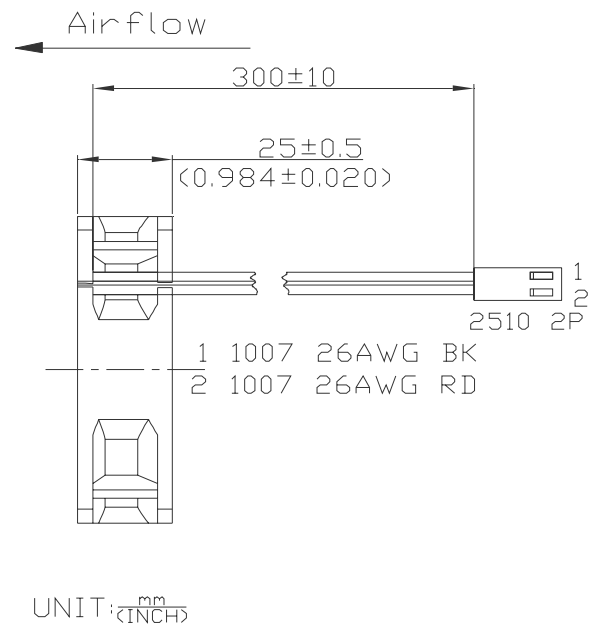
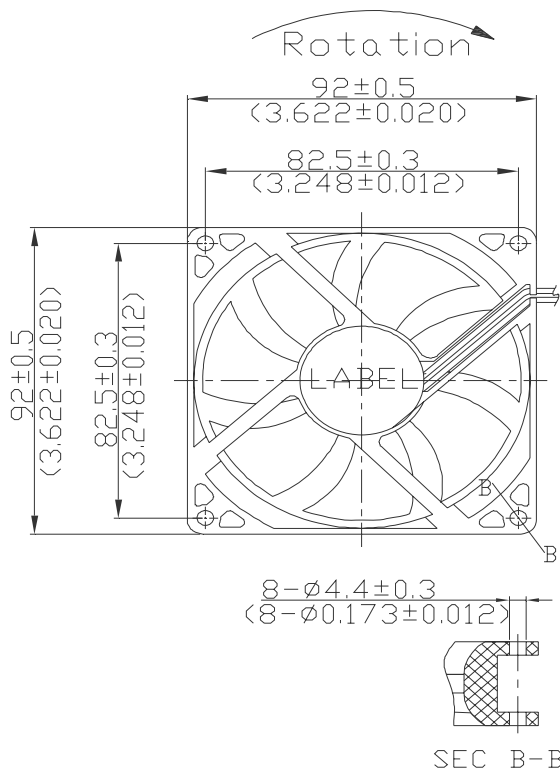

## VIII. P/Q Performance

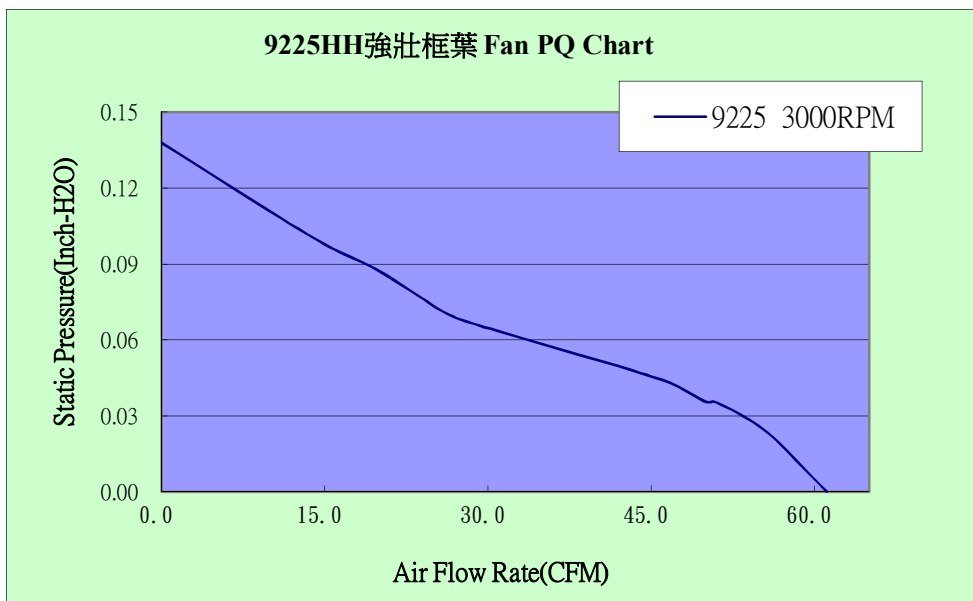

|    | Q(cfm) | Ps(InchH2o) |
|----|--------|-------------|
| 1  | 0.000  | 0.138       |
| 2  | 13.983 | 0.100       |
| 3  | 19.457 | 0.089       |
| 4  | 23.818 | 0.077       |
| 5  | 27.458 | 0.068       |
| 6  | 45.767 | 0.045       |
| 7  | 49.897 | 0.036       |
| 8  | 51.037 | 0.035       |
| 9  | 55.587 | 0.024       |
| 10 | 61.114 | 0.000       |