

HCBB60S





Metallized polypropylene film AC motor capacitor (S3 safety protection, cylindrical, plastic case)



Features

- Widely applied to starting and running of AC single-phase motors at 50/60Hz frequency power
- Encapsulated in flame-resistant plastic case, sealed with epoxy resin
- Self-healing property
- Stable performance and high reliability
- Adopt isolation film design, meet with S3 safety protection

Safety Approvals

	CQC	GB/T 3667.1	<p>1μF-60μF, \pm5%, 250Va.c.-300Va.c. 40/70/21, 40/85/21, B/C, S3, SH, 50/60Hz File No.: CQC16006150760</p> <p>1μF-60μF, \pm5%, 450Va.c.-500Va.c. 40/70/21, 40/85/21, B/C, S3, SH, 50/60Hz File No.: CQC16006150762</p>
	TUV	EN 60252-1	<p>1μF-60μF, \pm5%, 220Va.c.-500Va.c. 40/70/21, 40/85/21, B, S3, SH, 50/60Hz File No.: R 50258744</p>
	CE	2014/35/EU	<p>1μF-60μF, \pm5%, 220Va.c.-500Va.c. 40/70/21, 40/85/21, B, S3, SH, 50/60Hz File No.: AN 50508680 0001</p>
	UL	UL810	<p>1μF-90μF, \pm5%, max 500Va.c. max 85°C, 50/60Hz, "Protected", 10000AFC File No.: E481493, CCN:CYWT2</p>

Outline Drawing

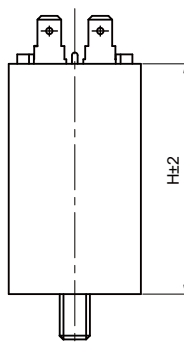

a) Tabs

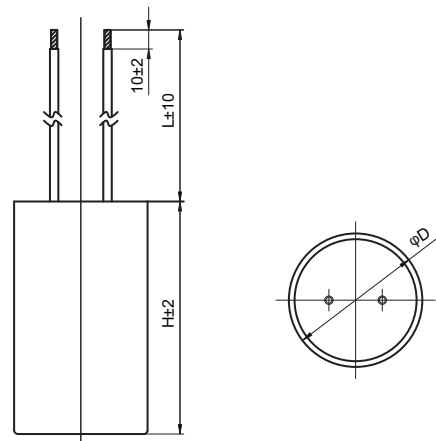

b) Lead wires

Specifications

Reference standard		GB/T 3667.1 (IEC 60252-1)
Rated voltage		250Va.c. ~ 500Va.c.(50Hz/60Hz)
Class of operation		Class B(10000h)
Capacitance range		1μF ~ 60μF
Climatic category		40/70/21,40/85/21
Class of safety protection		S3
Operation temperature range		-40°C~70°C / -40°C~85°C
Capacitance tolerance		±5%(J)
Voltage proof	Between terminals	2U _{NAC} (2s)
	Between terminals and case	2000Va.c. (60s)
Insulation resistance(IR×C _N)		≥3000s(20°C,100Vd.c.,60s)
Dissipation factor		≤0.0020(100Hz,20°C)
Max permissible voltage		1.1U _N
Max permissible current		1.3I _N

Ordering Information

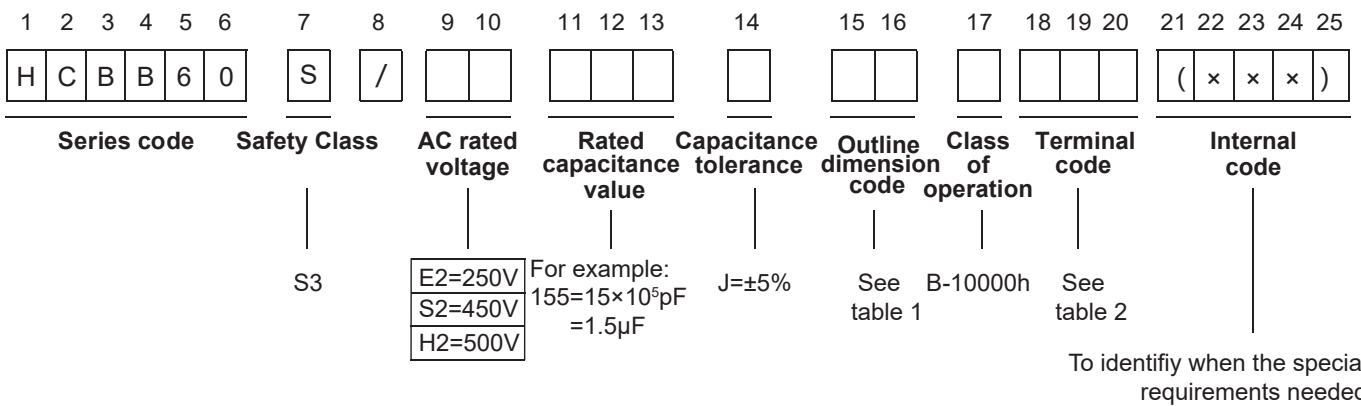

Table 1 Outline Dimensions Code

Digit 15		Digit 16			
Code	D(mm)	Code	H(mm)	Code	H(mm)
1	25	1	38	E	75
2	28	2	43	F	76
3	30	3	48	G	80
4	32	4	50	H	85
5	35	5	52	J	90
6	40	6	53	K	95
7	41	7	54	L	100
8	45	8	55	M	110
9	50	9	57	N	115
A	55	A	58	P	120
B	60	B	62	R	30
		C	65	S	40
		D	70	Q	72

Table 2 Terminal Code

Digit 18		Digit 19		Digit 20	
Code	Terminal form	Code	Fixed style	Code	Length tolerance
1	One AMP250# per side	0	No bottom-bolt	0	Standard lead wire:140mm±10mm or tabs
2	Two AMP250# per side	2	With bottom-bolt	L	Customized length and tolerance
6	Lead wires				

Outline Dimensions

C _N (μF)	250Va.c.(Class B) (Tabs)			250Va.c. (Class B) (Insulated flexible lead wires)		
	D±1 (mm)	H±2 (mm)	Ordering Information	D±1 (mm)	H±2 (mm)	Ordering Information
2.5	25	43	HCBB60S/E2255J12B**0	25	38	HCBB60S/E2255J11B6*0
3.0	25	43	HCBB60S/E2305J12B**0	25	38	HCBB60S/E2305J11B6*0
4.0	25	43	HCBB60S/E2405J12B**0	25	38	HCBB60S/E2405J11B6*0
5.0	25	54	HCBB60S/E2505J17B**0	25	48	HCBB60S/E2505J13B6*0
5.5	25	54	HCBB60S/E2555J17B**0	25	48	HCBB60S/E2555J13B6*0
6.0	25	54	HCBB60S/E2605J17B**0	25	48	HCBB60S/E2605J13B6*0
6.5	25	54	HCBB60S/E2655J17B**0	25	48	HCBB60S/E2655J13B6*0
7.0	28	53	HCBB60S/E2705J26B**0	28	48	HCBB60S/E2705J23B6*0
7.5	28	53	HCBB60S/E2755J26B**0	28	48	HCBB60S/E2755J23B6*0
8.0	28	53	HCBB60S/E2805J26B**0	28	48	HCBB60S/E2805J23B6*0
8.5	28	53	HCBB60S/E2855J26B**0	28	48	HCBB60S/E2855J23B6*0
9.0	28	53	HCBB60S/E2905J26B**0	28	48	HCBB60S/E2905J23B6*0
10	32	57	HCBB60S/E2106J49B**0	32	50	HCBB60S/E2106J44B6*0
12	32	57	HCBB60S/E2126J49B**0	32	50	HCBB60S/E2126J44B6*0
14	32	57	HCBB60S/E2146J49B**0	32	50	HCBB60S/E2146J44B6*0
15	32	57	HCBB60S/E2156J49B**0	32	50	HCBB60S/E2156J44B6*0
16	35	70	HCBB60S/E2166J5DB**0	35	62	HCBB60S/E2166J5BB6*0
18	35	70	HCBB60S/E2186J5DB**0	35	62	HCBB60S/E2186J5BB6*0
20	35	70	HCBB60S/E2206J5DB**0	35	62	HCBB60S/E2206J5BB6*0
24	35	75	HCBB60S/E2246J5EB**0	35	70	HCBB60S/E2246J5DB6*0
25	35	75	HCBB60S/E2256J5EB**0	35	70	HCBB60S/E2256J5DB6*0
28	40	70	HCBB60S/E2286J6DB**0	41	65	HCBB60S/E2286J7CB6*0
30	40	70	HCBB60S/E2306J6DB**0	41	65	HCBB60S/E2306J7CB6*0
35	41	80	HCBB60S/E2356J7GB**0	41	76	HCBB60S/E2356J7FB6*0
40	41	80	HCBB60S/E2406J7GB**0	41	76	HCBB60S/E2406J7FB6*0
42	41	80	HCBB60S/E2426J7GB**0	41	76	HCBB60S/E2426J7FB6*0
45	45	80	HCBB60S/E2456J8GB**0	45	75	HCBB60S/E2456J8EB6*0
48	45	80	HCBB60S/E2486J8GB**0	45	75	HCBB60S/E2486J8EB6*0

Notes:1) "***0"= tabs terminal code. Various installations can be provided. Please choose the type according to table 2 and contact us for specific installation requirements;

2) "6*0"= lead wires code. Various installations can be provided. Please choose the type according to table 2 and contact us for specific installation requirements.

Outline Dimensions

C _N (μF)	250Va.c.(Class B) (Tabs)			250Va.c. (Class B) (Insulated flexible lead wires)		
	D±1 (mm)	H±2 (mm)	Ordering Information	D±1 (mm)	H±2 (mm)	Ordering Information
48	45	80	HCBB60S/E2486J8GB**0	45	75	HCBB60S/E2486J8EB6*0
50	45	80	HCBB60S/E2506J8GB**0	45	75	HCBB60S/E2506J8EB6*0
52	45	80	HCBB60S/E2526J8GB**0	45	75	HCBB60S/E2526J8EB6*0
55	45	80	HCBB60S/E2556J8GB**0	45	75	HCBB60S/E2556J8EB6*0
60	45	90	HCBB60S/E2606J8JB**0	45	85	HCBB60S/E2606J8HB6*0
65	50	90	HCBB60S/E2656J9JB**0	50	85	HCBB60S/E2656J9HB6*0
70	50	90	HCBB60S/E2706J9JB**0	50	85	HCBB60S/E2706J9HB6*0
75	50	90	HCBB60S/E2756J9JB**0	50	85	HCBB60S/E2756J9HB6*0
80	50	95	HCBB60S/E2806J9KB**0	50	90	HCBB60S/E2806J9JB6*0
85	55	95	HCBB60S/E2856JAKB**0	55	95	HCBB60S/E2856JAKB6*0
90	55	95	HCBB60S/E2906JAKB**0	55	95	HCBB60S/E2906JAKB6*0
100	55	100	HCBB60S/E2107JALB**0	55	95	HCBB60S/E2107JAKB6*0

C _N (μF)	450Va.c. (Class B) (Tabs)			450Va.c. (Class B) (Insulated flexible lead wire)		
	D±1 (mm)	H±2 (mm)	Ordering Information	D±1 (mm)	H±2 (mm)	Ordering Information
1.5	25	43	HCBB60S/S2155J12B**0	25	38	HCBB60S/S2155J11B6*0
2.0	25	43	HCBB60S/S2205J12B**0	25	38	HCBB60S/S2205J11B6*0
2.25	25	53	HCBB60S/S22N4J16B**0	25	48	HCBB60S/S22N4J13B6*0
2.5	25	53	HCBB60S/S2255J16B**0	25	48	HCBB60S/S2255J13B6*0
3.0	28	58	HCBB60S/S2305J2AB**0	28	43	HCBB60S/S2305J22B6*0
3.5	28	58	HCBB60S/S2355J2AB**0	28	53	HCBB60S/S2355J26B6*0
4.0	28	58	HCBB60S/S2405J2AB**0	28	53	HCBB60S/S2405J26B6*0
4.5	28	58	HCBB60S/S2455J2AB**0	28	53	HCBB60S/S2455J26B6*0
5.0	32	50	HCBB60S/S2505J44B**0	32	53	HCBB60S/S2505J46B6*0
5.5	32	57	HCBB60S/S2555J49B**0	32	53	HCBB60S/S2555J46B6*0

Notes:1) "**0"= tabs terminal code.Various installations can be provided. Please choose the type according to table 2 and contact us for specific installation requirements;

2) "6*0"= lead wires code.Various installations can be provided. Please choose the type according to table 2 and contact us for specific installation requirements.

Outline Dimensions

C _N (μF)	450Va.c. (Class B) (Tabs)			450Va.c. (Class B) (Insulated flexible lead wire)		
	D±1 (mm)	H±2 (mm)	Ordering Information	D±1 (mm)	H±2 (mm)	Ordering Information
6.0	32	57	HCBB60S/S2605J49B**0	32	53	HCBB60S/S2605J46B6*0
6.5	32	57	HCBB60S/S2655J49B**0	32	53	HCBB60S/S2655J46B6*0
7.0	32	57	HCBB60S/S2705J49B**0	32	53	HCBB60S/S2705J46B6*0
8.0	35	57	HCBB60S/S2805J59B**0	35	55	HCBB60S/S2805J58B6*0
9.0	35	57	HCBB60S/S2905J59B**0	35	55	HCBB60S/S2905J58B6*0
10	35	70	HCBB60S/S2106J5DB**0	35	62	HCBB60S/S2106J5BB6*0
12	35	75	HCBB60S/S2126J5EB**0	35	70	HCBB60S/S2126J5DB6*0
12.5	35	75	HCBB60S/S212EJ5EB**0	35	70	HCBB60S/S212E6J5DB6*0
13	35	75	HCBB60S/S2136J5EB**0	35	70	HCBB60S/S2136J5DB6*0
14	35	75	HCBB60S/S2146J5EB**0	35	70	HCBB60S/S2146J5DB6*0
15	40	70	HCBB60S/S2156J6DB**0	41	65	HCBB60S/S2156J7CB6*0
16	40	70	HCBB60S/S2166J6DB**0	41	65	HCBB60S/S2166J7CB6*0
18	41	76	HCBB60S/S2186J7FB**0	41	76	HCBB60S/S2186J7FB6*0
20	41	76	HCBB60S/S2206J7FB**0	41	76	HCBB60S/S2206J7FB6*0
25	45	80	HCBB60S/S2256J8GB**0	45	70	HCBB60S/S2256J8DB6*0
30	45	90	HCBB60S/S2306J8JB**0	45	85	HCBB60S/S2306J8HB6*0
35	45	95	HCBB60S/S2356J8KB**0	45	90	HCBB60S/S2356J8JB6*0
40	50	100	HCBB60S/S2406J9LB**0	50	95	HCBB60S/S2406J9KB6*0
45	50	100	HCBB60S/S2456J9LB**0	50	95	HCBB60S/S2456J9KB6*0
50	55	100	HCBB60S/S2506JALB**0	55	95	HCBB60S/S2506JAKB6*0
55	55	100	HCBB60S/S2556JALB**0	55	95	HCBB60S/S2556JAKB6*0
60	55	110	HCBB60S/S2606JAMB**0	55	100	HCBB60S/S2606JALB6*0

Notes:1) "**0"= tabs terminal code.Various installations can be provided. Please choose the type according to table 2 and contact us for specific installation requirements;

2) "6*0"= lead wires code.Various installations can be provided. Please choose the type according to table 2 and contact us for specific installation requirements.

Outline Dimensions

C _N (μF)	500Va.c. (Class B) (Tabs)			500Va.c. (Class B) (Insulated flexible lead wire)		
	D±1 (mm)	H±2 (mm)	Ordering Information	D±1 (mm)	H±2 (mm)	Ordering Information
1.5	25	43	HCBB60S/H2155J12B**0	25	38	HCBB60S/H2155J11B6*0
2.0	25	48	HCBB60S/H2205J13B**0	25	43	HCBB60S/H2205J12B6*0
2.5	30	48	HCBB60S/H2255J33B**0	30	48	HCBB60S/H2255J33B6*0
3.0	30	48	HCBB60S/H2305J33B**0	30	48	HCBB60S/H2305J33B6*0
3.5	30	55	HCBB60S/H2355J38B**0	30	48	HCBB60S/H2355J33B6*0
4.0	30	55	HCBB60S/H2405J38B**0	30	48	HCBB60S/H2405J33B6*0
4.5	32	57	HCBB60S/H2455J49B**0	32	50	HCBB60S/H2455J44B6*0
5.0	32	57	HCBB60S/H2505J49B**0	32	50	HCBB60S/H2505J44B6*0
5.5	35	57	HCBB60S/H2555J59B**0	35	55	HCBB60S/H2555J58B6*0
6.0	35	57	HCBB60S/H2605J59B**0	35	55	HCBB60S/H2605J58B6*0
6.5	35	57	HCBB60S/H2655J59B**0	35	55	HCBB60S/H2655J58B6*0
7.0	35	57	HCBB60S/H2705J59B**0	35	55	HCBB60S/H2705J58B6*0
7.5	35	62	HCBB60S/H2755J5BB**0	35	55	HCBB60S/H2755J58B6*0
8.0	35	62	HCBB60S/H2805J5BB**0	35	55	HCBB60S/H2805J58B6*0
9.0	40	70	HCBB60S/H2905J6DB**0	41	65	HCBB60S/H2905J7CB6*0
10	40	70	HCBB60S/H2106J6DB**0	41	65	HCBB60S/H2106J7CB6*0
12	40	70	HCBB60S/H2126J6DB**0	41	65	HCBB60S/H2126J7CB6*0
12.5	45	72	HCBB60S/H212EJ8QB**0	45	72	HCBB60S/H212EJ8QB6*0
13	45	72	HCBB60S/H2136J8QB**0	45	72	HCBB60S/H2136J8QB6*0
14	45	72	HCBB60S/H2146J8QB**0	45	72	HCBB60S/H2146J8QB6*0
15	45	72	HCBB60S/H2156J8QB**0	45	72	HCBB60S/H2156J8QB6*0
16	45	72	HCBB60S/H2166J8QB**0	45	72	HCBB60S/H2166J8QB6*0
18	45	85	HCBB60S/H2186J8HB**0	45	80	HCBB60S/H2186J8GB6*0
20	45	85	HCBB60S/H2206J8HB**0	45	80	HCBB60S/H2206J8GB6*0
25	50	85	HCBB60S/H2256J9HB**0	50	85	HCBB60S/H2256J9HB6*0
30	50	95	HCBB60S/H2306J9KB**0	50	85	HCBB60S/H2306J9HB6*0
35	50	100	HCBB60S/H2356J9LB**0	50	95	HCBB60S/H2356J9KB6*0
40	55	100	HCBB60S/H2406JALB**0	55	95	HCBB60S/H2406JAKB6*0
45	55	110	HCBB60S/H2456JAMB**0	55	100	HCBB60S/H2456JALB6*0
50	55	120	HCBB60S/H2506JAPB**0	55	110	HCBB60S/H2506JAMB6*0
55	60	120	HCBB60S/H2556JBPB**0	60	115	HCBB60S/H2556JBNB6*0
60	60	120	HCBB60S/H2606JBPB**0	60	115	HCBB60S/H2606JBNB6*0

Notes:1) "***0"= tabs terminal code. Various installations can be provided. Please choose the type according to table 2 and contact us for specific installation requirements;

2) "6*0"= lead wires code. Various installations can be provided. Please choose the type according to table 2 and contact us for specific installation requirements.