

## DC Power Plug Series

KLS1-DC-002A (DC Power Socket)

### Technical parameters:

Contact resistance: 0.03Ω, max  
 Insulation resistance: 100MΩ, min  
 Pressure: AC500V (50Hz) / 1minute  
 Rated Load: DC 16V 2.0A Max  
 Actuating Force: 3~20N  
 Life: 5000 times  
 Operating Temperature:-30°C ~ 70°C

### Material:

Centre Pin : Copper  
 Terminal 1 : Brass  
 Terminal 2 : Copper alloy  
 Terminal 3 : Brass  
 Housing : PBT  
 Cover : PBT

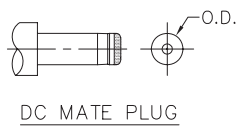
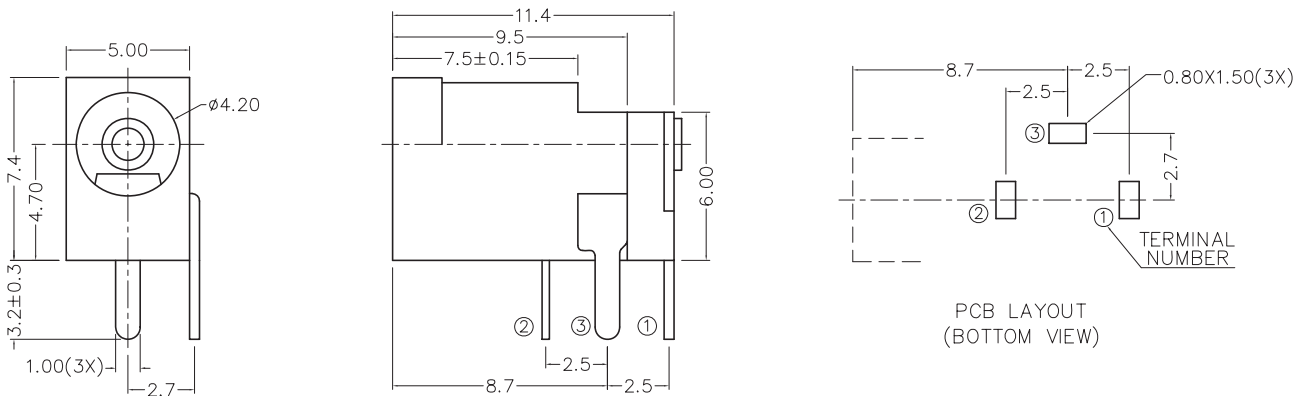

MODEL NO.	DC-002A	DC-002AA	DC-002AB
SCHEMATIC			
CENTER PIN	ø1mm	ø1.3mm	ø1.65mm
DC PLUG O.D.	ø3.4mm/ø3.8mm	ø3.4mm/ø3.8mm	ø3.8mm/ø4mm

## ORDER INFORMATION

Product NO.: KLS1-DC-002A-1.0-A

