

RoHS Compliance

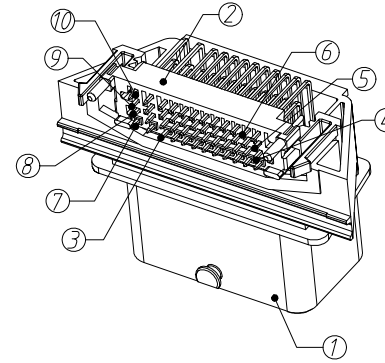

Material:

- ① Wafer: PBT+GF, Black, 1 PCS
- ② Lock: PBT+GF, Black, 1 PCS
- ③ Pin: Brass, Tin-Pated, 10 PCS
- ④ Pin: Brass, Tin-Pated, 10 PCS
- ⑤ Pin: Brass, Tin-Pated, 10 PCS
- ⑥ Pin: Brass, Tin-Pated, 10 PCS
- ⑦ Pin: Brass, Tin-Pated, 2 PCS
- ⑧ Pin: Brass, Tin-Pated, 2 PCS
- ⑨ Pin: Brass, Tin-Pated, 2 PCS
- ⑩ Pin: Brass, Tin-Pated, 2 PCS

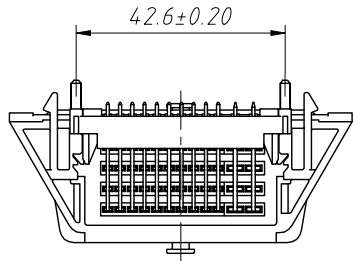
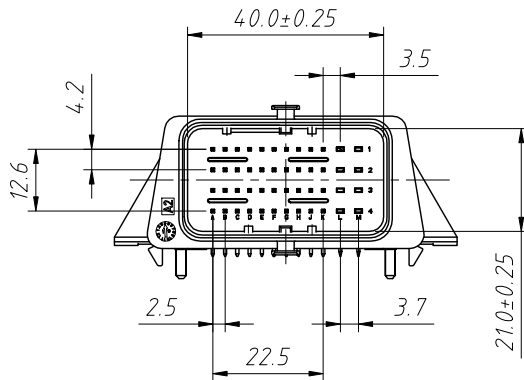
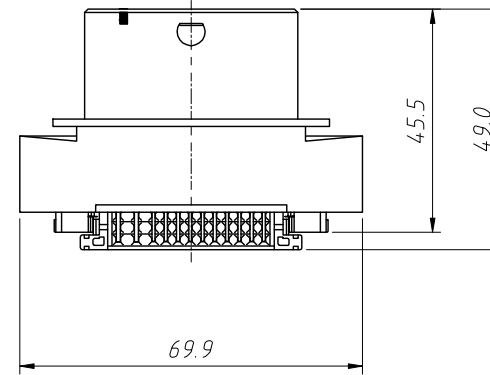
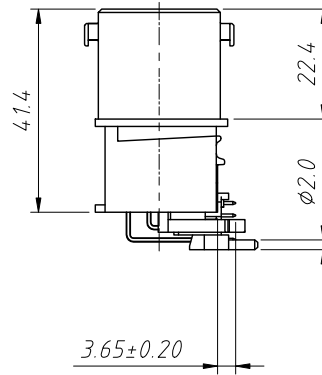
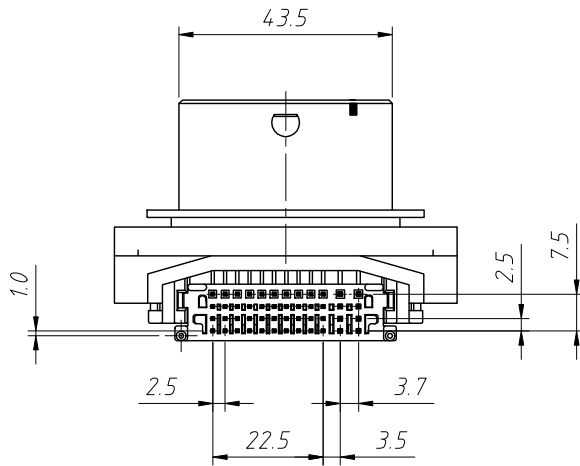

Note:

1. Parts shall not have any flash or injection defects that may affect the using, no obvious solution mark etc.
2. No. Tolerances GB/T14486-2008-MT6

Order Information:

L-KLS13-CA116-0.7/1.5-48-R-B

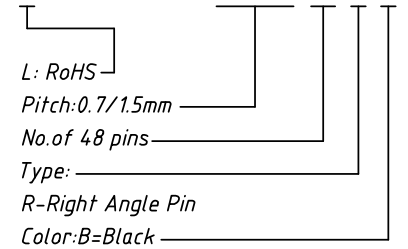

ANGLE TOLERANCE	PROJECTION	Description:
±3°		48 Ways Wafer, Automobile connector
GENERAL TOLERANCE	UNITS	mm
x.x ±0.30	SHEET SIZE	A4
x.xx ±0.20	Draw:	Daniel 2022-07-13
x.xxx ±0.10	Check:	Daniel 2022-07-13



KLS ELECTRONIC CO.,LTD.