

Circular Connector

Russia Standard PC Type

KLS15-RCS01-PC4 type small connector

KLS15-RCS01-PC series are used widely in all kinds of electronic equipment. This connect is small in size and light in weight. The flange are round and square.

Technical characteristics

Operating voltage: 250V

Rated current: 5A

Contact Resistance: $<5\text{M}\Omega$

Insulation resistance: $<3000\text{M}\Omega$

Temperature: $-55^{\circ}\text{C}\sim+125^{\circ}\text{C}$

Relative Humidity: 93% at $40\pm 2^{\circ}\text{C}$

Atmospheric pressure: 101.33~6.7kpa

Vibration, the peak impact acceleration: 10~2000Hz 196m/s²

Mechanical shock, the peak impact acceleration: 196m/s²

Endurance: 500cycles

Water proof: IP ≥ 68

The connect is water-repellent in one meter deep water for 30 minutes



XV

Structure of Insulator

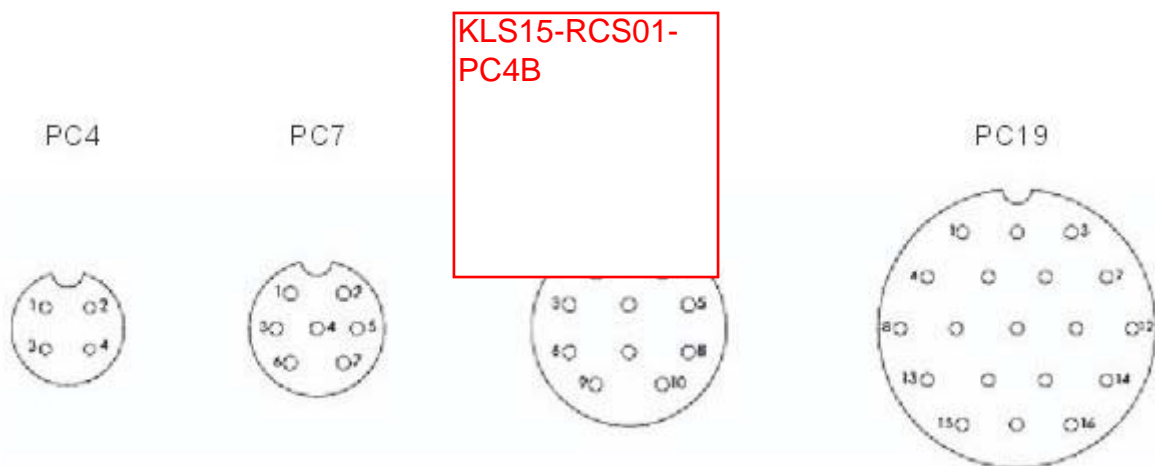

ORDER INFORMATION

Product NO.: KLS15-RCS01-PC4 T B

Pins: 4, 7, 10, 19pin

Type: T-Plug (Female+Cover)
B-Flange Receptacle
F-Female Plug
C-Cover



T-Plug (Female+Cover)



B-Flange Receptacle



C-Cover

Circular Connector

Russia Standard PC Type

KLS15-RCS01-PC4 type small connector

Dimension: (mm)

PC4-T/B

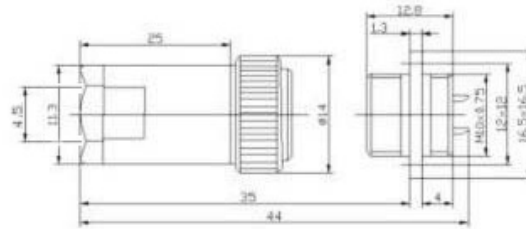

PC7-T/B

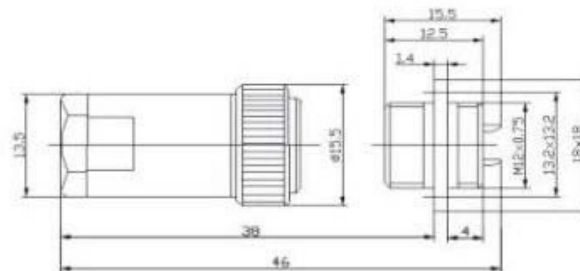

PC10-T/B

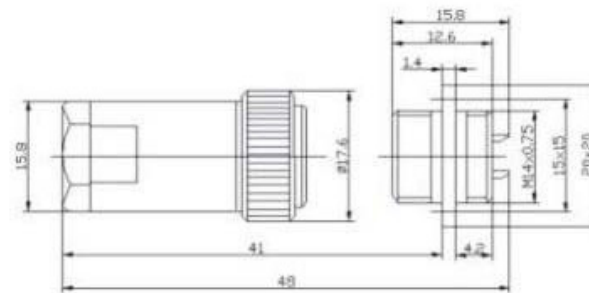

PC19-T/B

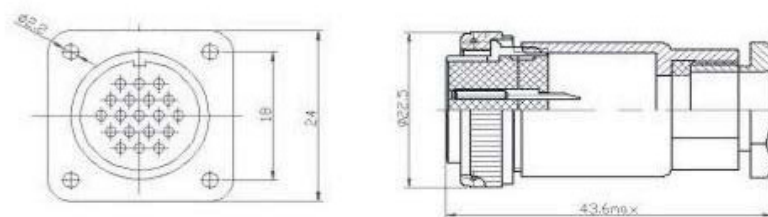

ORDER INFORMATION

Product NO.: KLS15-RCS01-PC4 T B

Pins: 4, 7, 10, 19pin

Type: T-Plug (Female+Cover)
B-Flange Receptacle
F- Female Plug
C-Cover



T-Plug (Female+Cover)



B-Flange Receptacle



C-Cover