



Externally driven piezo buzzer

1	TYPE	L-KLS3-PT-12*06
2	RATED VOLTAGE (Vp-p)	12 (3Vp-p~12Vp-p Customizable)
3	MAX.ALLOWABLE VOLTAGE (Vp-p)	30
4	*RATED CURRENT (mA)	≤6
5	*CAPACITANCE 120Hz (PF)	15000±30%
6	RESONANT FREQUENCY (Hz)	4000±500
7	*SOUND PRESSURE LEVEL (dB)	≥80 at 10cm
8	OPERATING TEMPERATURE (°C)	-40~+85
9	STORAGE TEMPERATURE (°C)	-40~+105
10	WEIGHT (g)	1.0
11	RoHS	Yes

*Applying rated voltage (Resonant frequency, Square wave)

DIMENSIONS (UNIT: mm)

Tolerance: ±0.5mm Except Specified

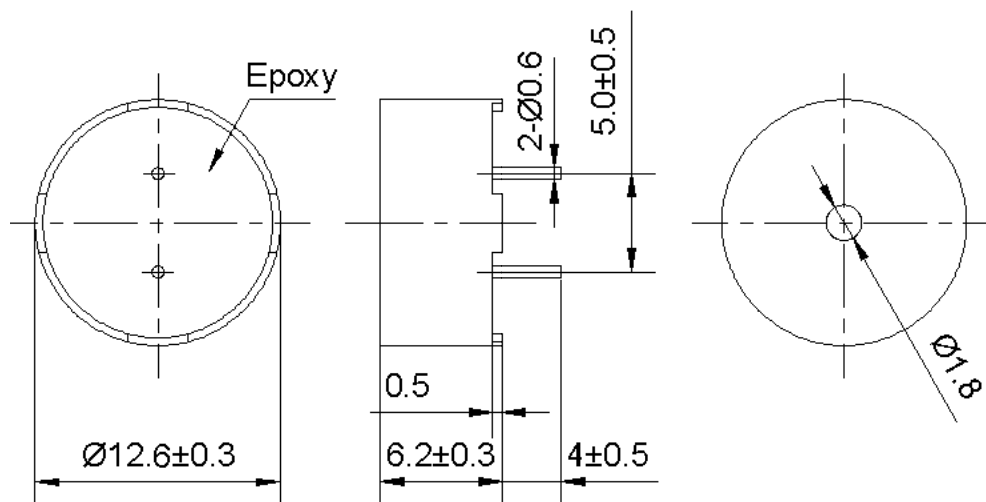

NingBo KLS ELECTRONIC CO.,LTD.

*Housing Material: PPO

TEST METHOD:

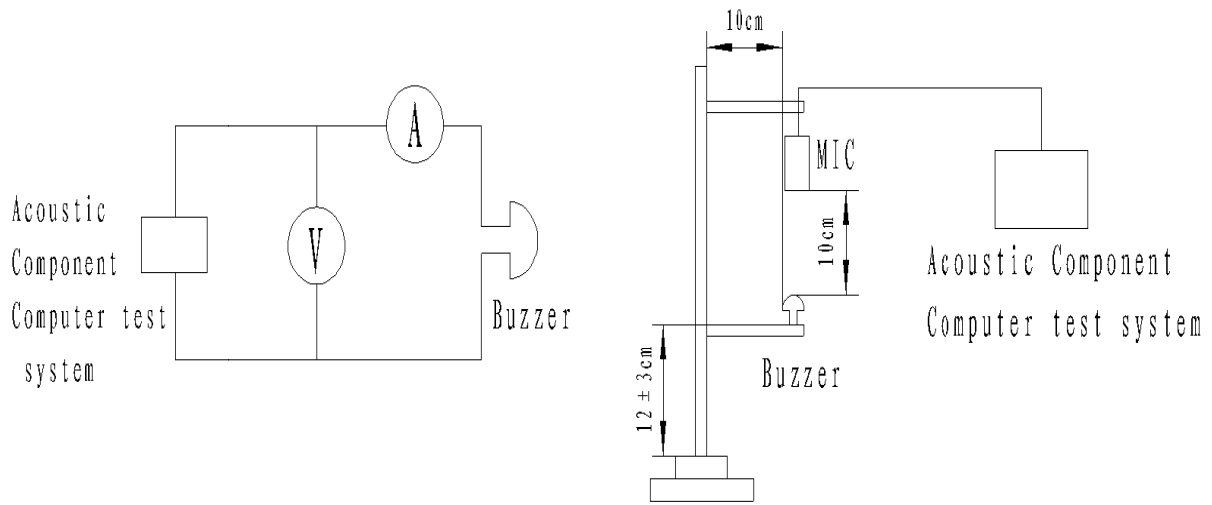

FREQUENCY RESPONSE:

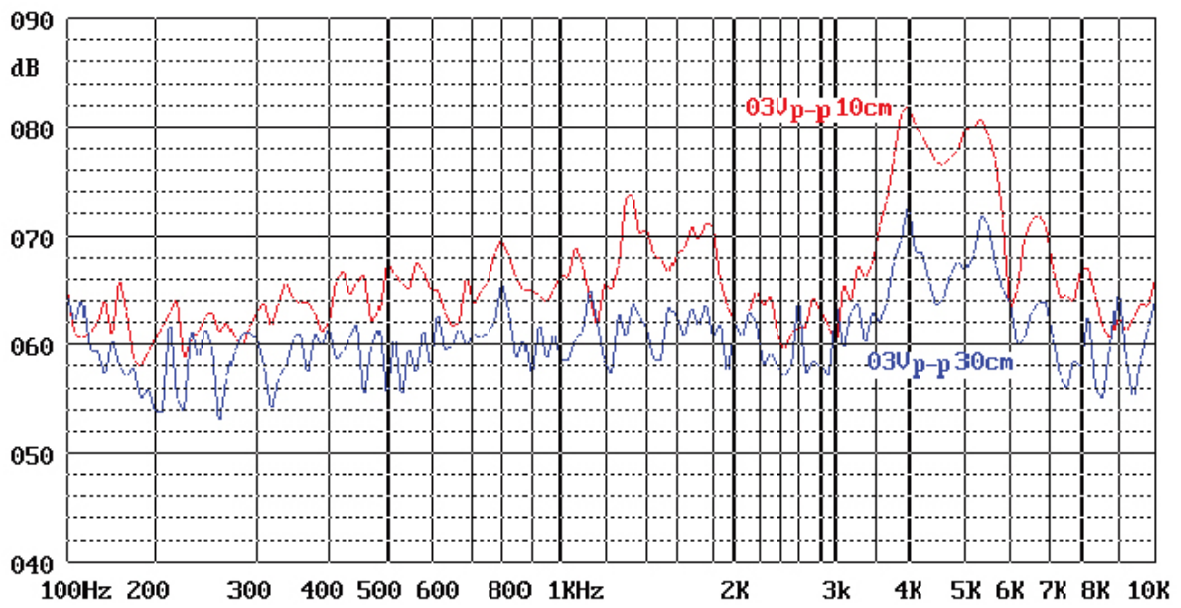

RELIABLY TEST:

NO.	ITEM	TESTING CONDITION	VARIANCE AFTER TEST
1	Humidity	$40 \pm 2^{\circ}\text{C}$, 93(+2/-3)%RH, 96HRS	All specifications must be satisfied after the test.
2	High temp.	$+80 \pm 2^{\circ}\text{C}$, 96HRS	
3	Low temp.	$-30 \pm 2^{\circ}\text{C}$, 96HRS	
4	Temperature cycling	$-30 \pm 2^{\circ}\text{C}$, 30minutes room temp. 15minutes $+80 \pm 2^{\circ}\text{C}$, 30minutes room temp. 15minutes 5 cycles	
5	Drop test	3 times from height of 70cm onto the surface of 10mm thick wooden board.	
6	Vibration test	Make the test for the directions of X Y and Z (total 0.5 hours). To-and-fro. sweep time (from 10 to 55 Hz and then 55 to 10) under single amplitude of 10mm is3minute.	
7	Solder heat resistance	The part leads (pins) shall be immersed in molten solder maintained at $250 \pm 10^{\circ}\text{C}$ for a period of 30 seconds.	

PACKING:

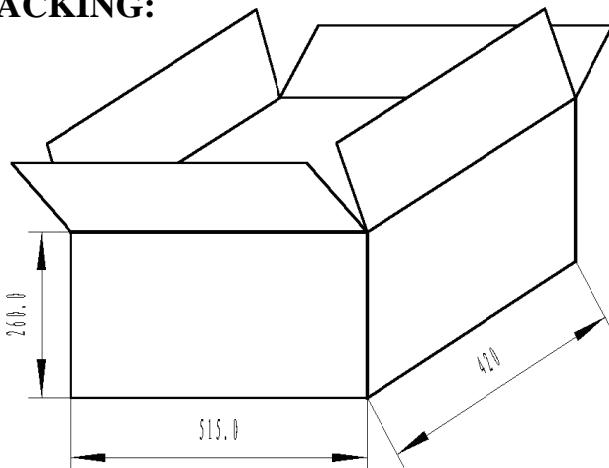

NOTES:

- 1.100 PCS per box
- 2.Total 50 boxes per carton
- 3.Total 5000 PCS carton
- 4.Volume: 51.5*42*26cm



NingBo KLS ELECTRONIC CO.,LTD.