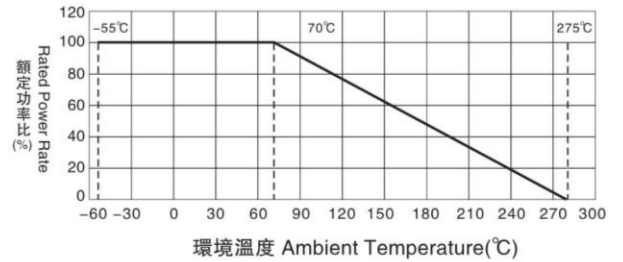
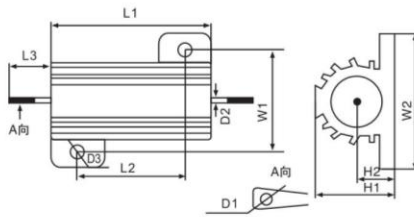
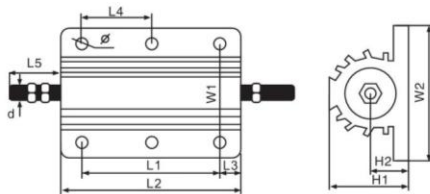

■ 特性 Feature

1. 金屬鋁殼包封, 散熱性能好, 適合散熱板安裝, 可長期在惡劣環境下使用
2. 體積小, 功率負荷大
3. 絕緣性高, 採用阻燃無機材料一體化封裝, 抗振性好
4. 多種接線方式, 便於安裝
5. 廣泛用於電源、變頻器、電梯、舞臺音響及高端設備行業

■ 降功率曲線 Derating Curve

■ 尺寸 Dimension

功率 Power	尺寸 Dimensions (mm)										阻值範圍 Resistance range
	L1 ± 1	L2 ± 1	L3 ± 1	W1 ± 1	W2 ± 1	H1 ± 1	H2 ± 1	D1 ± 0.5	D2 ± 0.1	D3 ± 0.5	
5W	15.5	11.0	26.0	12.0	16.0	8.5	4.4	1.5	1.5	2.4	0R01-1K
10W	20.0	14.0	9.0	16.0	21.0	10.0	5.0	2.0	2.0	2.5	0R01-1K5
25W	28.0	18.0	11.0	20.0	27.0	14.0	7.0	2.0	2.0	3.5	0R01-10K
30W	34.0	25.0	11.0	21.5	29.0	15.5	7.3	2.0	2.0	3.5	0R01-27K
50W	50.0	40.0	11.0	21.5	29.0	15.5	7.3	2.0	2.0	3.5	0R01-33K



功率 Power	尺寸 Dimensions (mm)											阻值範圍 Resistance Range
	L1 ± 2	L2 ± 2	L3 ± 1	L4 ± 1	L5 ± 2	W1 ± 2	W2 ± 2	H1 ± 1	H2 ± 1	d ± 0.5	ø ± 0.5	
75W	29.0	51.0	10.0	/	15.0	37.0	48.0	26.0	11.5	4.0	4.4	0R01-39K
100W	35.0	66.0	10.0	/	15.0	37.0	48.0	26.0	12.0	4.0	4.4	0R01-51K
150W	58.0	100.0	20.0	/	15.0	37.0	48.0	26.0	12.0	4.0	4.4	0R01-56K
200W	70.0	91.0	10.0	35.0	20.0	57.0	71.0	45.0	20.0	6.0	5.2	0R01-62K
250W	90.0	110.0	10.0	45.0	20.0	57.0	71.0	45.0	20.0	6.0	5.2	0R01-68K
300W	104.0	130.0	10.0	52.0	20.0	57.0	71.0	45.0	20.0	6.0	5.2	0R01-75K
500W	174.0	204.0	15.0	87.0	20.0	57.0	71.0	45.0	20.0	6.0	5.2	0R01-82K

■ 電氣性能 Electrical performance

Characteristics	Specifications	Test Methods
Short-time overload	10PR, 5S	± (2% + 0.05 Ω) Max.
Vibration	10HZ~55HZ~10HZ, 1.5mm, 2h	± (1% + 0.05 Ω) Max.
Heat resistant	350°C ± 5°C, 2h	± (2% + 0.05 Ω) Max.
Shock-proof	P _R , 30min/-55°C, 15min	± (2% + 0.05 Ω) Max.
Humidity-proof	40°C ± 2°C, RH93 ± 3%, 240h	± (3% + 0.05 Ω) Max.
Endurance	70°C, P _R , 500h	± (3% + 0.05 Ω) Max.