

本圖面若與目錄之規格尺寸不符，以本圖面規格尺寸為主。
Below is our main specification if different from catalog.

RoHS compliant

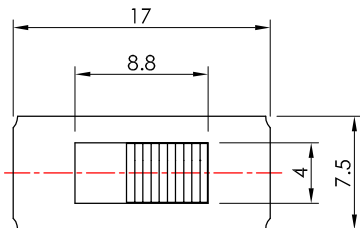

SCHMATIC
(NON-SHORTING)

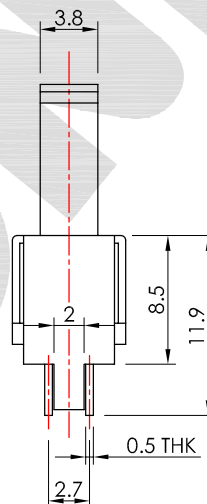
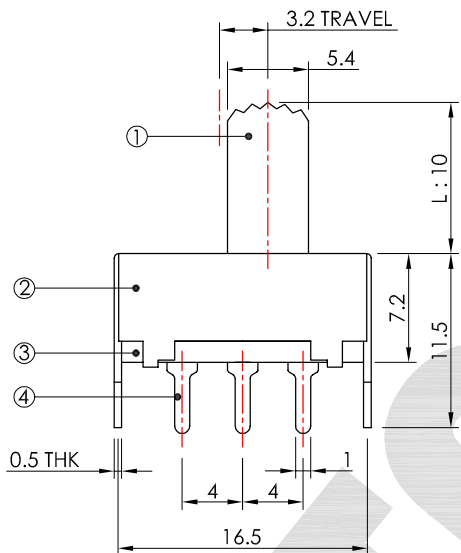
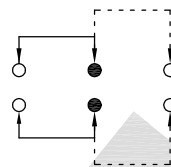

P.C.B LAYOUT

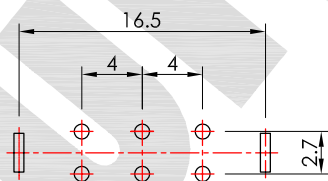

RoHS compliant

SS22F07GX-G

OPTIONAL KNOB SIZE (L)

4 - 18

SPECIFICATION

- Rating:** 0.5A 50V DC.
- Contact resistance:** 30mΩ Max.at 1A DC. (initial)
- Insulation resistance:** 100MΩ at 500V DC.
- Withstand voltage:** 500V AC for 1 minute.
- Switching life:** 10,000 Cycles
(unloading/15-18 Cycles per minute).
- Soldering temperature:** 230°C Max for 2±0.5 Sec.

MATERIAL

- Knob:** POM, black. ①
- Frame:** Steel strip, Ni plated. ②
- Terminal base:** Phenolic resin, natural. ③
- Terminal:** Brass strip, Ag plated over Ni plated. ④
- Spring:** Steel wire, temper.
- Contact:** Copper strip, Ag plated.



	△		
V2.1	無	改 版	2007.05.22
V2.0	無	新 繪 製	2004.11.17
版本 VER.	符號 SYMBOL	修 改 內 容 ALTERATION	更 新 日 期 DATE

產品 PRODUCT		Slide Switch		型號 MODEL NO.		SS22F07G10-G	
比例 SCALE	2 : 1	單位 UNIT	mm	<p>一綺電子企業股份有限公司</p> <p>總公司：110 台北市信義路四段415號12樓之2 12F-2 NO. 415, SEC. 4, HSIN YI ROAD, TAIPEI, TAIWAN TEL : 886-2-27290229(Rep.) FAX : 886-2-27582086 URL : http://www.switronic.com.tw E-MAIL : switches@ms36.hinet.net</p>			
公差 TOLERANCE	.X=±0.3mm, .XX=±0.2mm						
製圖 DRAWN BY	核圖 CHECKED BY	主管 APPROVED BY					
Danny Chen	Alex Lin	Margaret Lee					