



Rectifier Diode Modules

V_{RRM} 800 to 1600V

I_{FAV} 400 A

Applications

- Line rectifiers for transistorized AC motor controllers
- Field supply for DC motors
- Frequency inverter

Features

- International standard assembly
- Lower Forward voltage
- Insulation voltage 2500V

Circuit

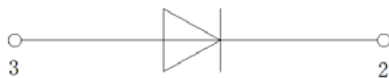

Module Type

TYPE	V _{RRM}	V _{RSM}
MD400U08I4	800V	900V
MD400U12I4	1200V	1300V
MD400U16I4	1600V	1700V

Maximum Ratings

Symbol	Conditions	Values	Units
I _{F(AV)}	Single phase ,half wave 180° conduction T _c =100°C	400	A
I _{F(RSM)}	Single phase ,half wave 180° conduction T _c =100°C	628	A
I _{FSM}	t=10mS T _{vj} =45°C	17000	A
i ² t	t=10mS T _{vj} =45°C	1470000	A ² s
V _{iso}	a.c.50HZ;r.m.s.;1min	2500	V
T _{vj}		-40 to +150	°C
T _{stg}		-40 to +125	°C
T _{jm}		150	°C
M _t	To terminals(M10)	12	Nm
M _s	To heatsink(M6)	6	Nm
Weight	Module (Approximately)	1300	g

Thermal Characteristics

Symbol	Conditions	Values	Units
R _{th(j-c)}	Per module	0.1	°C/W

Electrical Characteristics

Symbol	Conditions	Values			Units
		Min.	Typ.	Max.	
V _{FM}	T=25°C I _F =1200A	—		1.40	V
I _{RD}	T _{vj} =150°C V _{RD} =V _{RRM}	—	—	9	mA

Package Outline Information

CASE: I4

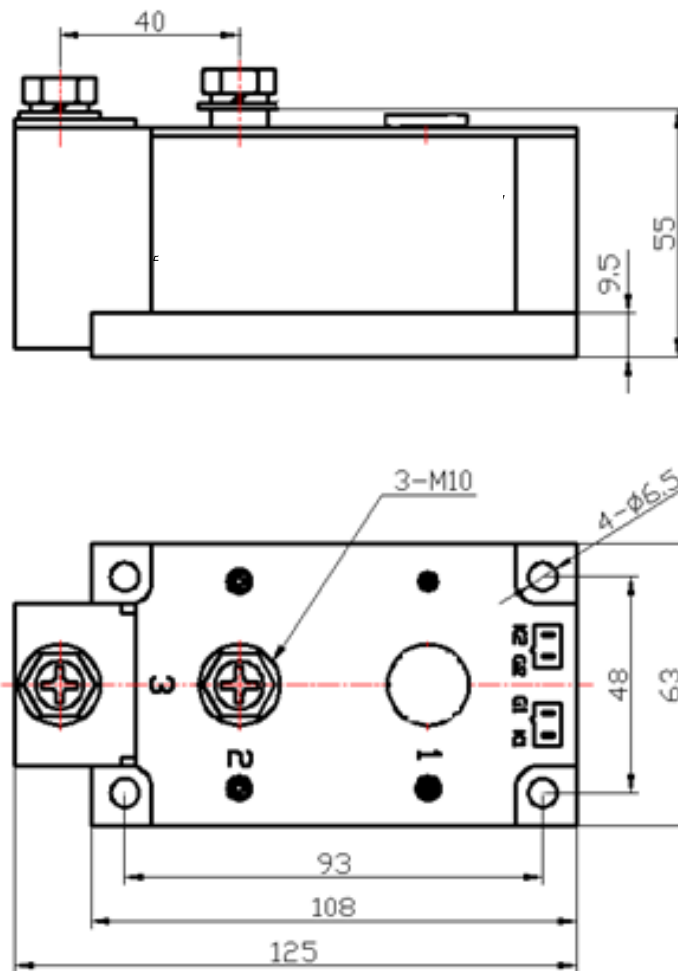

Dimensions in mm