

N-Channel Enhancement Mode Field Effect Transistor

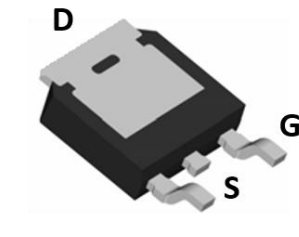

TO-252

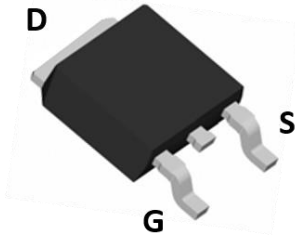
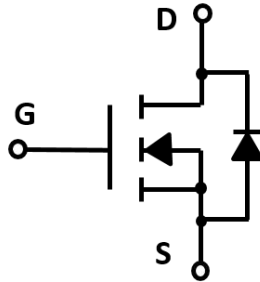

Product Summary

- V_{DS} 100V
- I_D 40A
- $R_{DS(ON)}$ (at $V_{GS}=10V$) <20 mohm
- $R_{DS(ON)}$ (at $V_{GS}=4.5V$) <26 mohm
- 100% UIS Tested
- 100% ∇V_{DS} Tested

General Description

- Low $R_{DS(on)}$ & FOM
- Extremely low switching loss
- Excellent stability and uniformity
- Fast switching and soft recovery

Applications

- Consumer electronic power supply
- Motor control
- Synchronous-rectification
- Isolated DC/DC convertor
- Invertors

■ Absolute Maximum Ratings ($T_A=25^\circ C$ unless otherwise noted)

Parameter	Symbol	Limit	Unit
Drain-source Voltage	V_{DS}	100	V
Gate-source Voltage	V_{GS}	± 20	V
Drain Current ^A	I_D	40	A
Pulsed Drain Current ^B	I_{DM}	120	A
Avalanche energy ^C	E_{AS}	30	mJ
Total Power Dissipation ^D	P_D	72	W
Thermal Resistance Junction-to-Case	$R_{\theta JC}$	1.74	$^\circ C/W$
Thermal Resistance Junction-to-Ambient ^E	$R_{\theta JA}$	62	$^\circ C/W$
Junction and Storage Temperature Range	T_J, T_{STG}	-55~+150	$^\circ C$

■ Ordering Information (Example)

PREFERRED P/N	PACKING CODE	Marking	MINIMUM PACKAGE(pcs)	INNER BOX QUANTITY(pcs)	OUTER CARTON QUANTITY(pcs)	DELIVERY MODE
YJD40G10A	F2	YJD40G10A	2500	/	25000	13" reel



YJD40G10A

■ Electrical Characteristics (T_J=25℃ unless otherwise noted)

Parameter	Symbol	Conditions	Min	Typ	Max	Units
Static Parameter						
Drain-Source Breakdown Voltage	BV _{DSS}	V _{GS} = 0V, I _D =250μA	100			V
Zero Gate Voltage Drain Current	I _{DSS}	V _{DS} =100V, V _{GS} =0V			1	μA
Gate-Body Leakage Current	I _{GSS}	V _{GS} = ±20V, V _{DS} =0V			±100	nA
Gate Threshold Voltage	V _{GS(th)}	V _{DS} = V _{GS} , I _D =250μA	1.0	1.8	2.5	V
Static Drain-Source On-Resistance	R _{DS(on)}	V _{GS} = 10V, I _D =8A		17	20	mΩ
		V _{GS} = 4.5V, I _D =6A		20	26	
Diode Forward Voltage	V _{SD}	I _S =40A, V _{GS} =0V			1.3	V
Maximum Body-Diode Continuous Current	I _S				40	A
Dynamic Parameters						
Input Capacitance	C _{iss}	V _{DS} =50V, V _{GS} =0V, f=1MHZ		1190		pF
Output Capacitance	C _{oss}			195		
Reverse Transfer Capacitance	C _{rss}			4.1		
Switching Parameters						
Total Gate Charge	Q _g	V _{GS} =10V, V _{DS} =50V, I _D =8A		20		nC
Gate-Source Charge	Q _{gs}			2.4		
Gate-Drain Charge	Q _{gd}			5.3		
Reverse Recovery Charge	Q _{rr}	I _F =8A, di/dt=100A/us		95		nC
Reverse Recovery Time	t _{rr}			50		
Turn-on Delay Time	t _{D(on)}	V _{GS} =10V, V _{DD} =50V, I _D =10A R _{GEN} =2.2Ω		17.5		ns
Turn-on Rise Time	t _r			3.9		
Turn-off Delay Time	t _{D(off)}			33.5		
Turn-off fall Time	t _f			3.2		

- A. Calculated continuous current based on maximum allowable junction temperature.
 B. Repetitive rating; pulse width limited by max. junction temperature.
 C. V_{DD}=50 V, R_G=25 Ω, L=0.3 mH, starting T_J=25 °C.
 D. P_D is based on max. junction temperature, using junction-case thermal resistance.
 E. The value of R_{JA} is measured with the device mounted on 1 in 2 FR-4 board with 2oz. Copper, in a still air environment with T_A=25 °C.



■ Typical Performance Characteristics

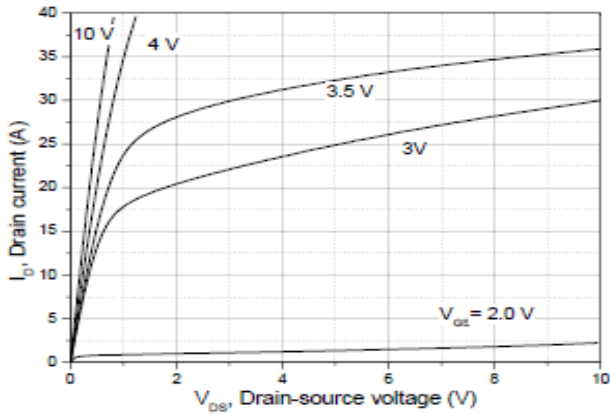

Figure1. Output Characteristics

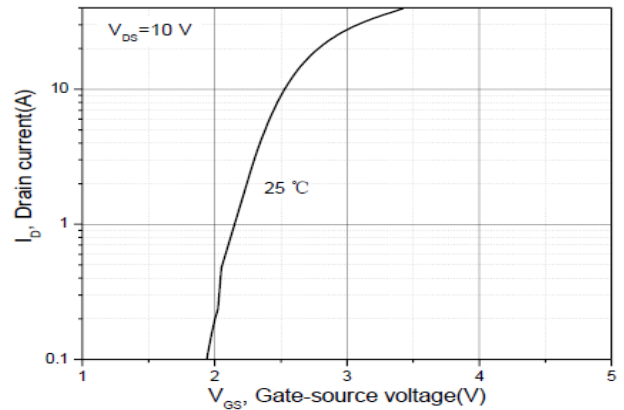

Figure2. Transfer Characteristics

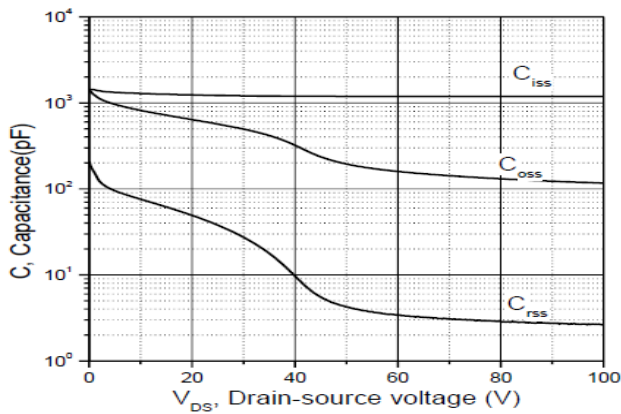

Figure3. Capacitance Characteristics

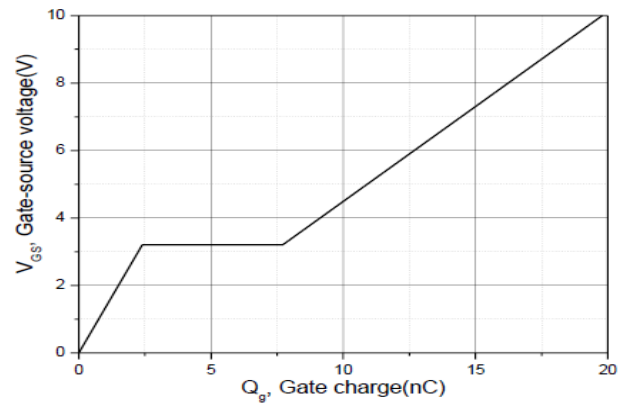

Figure4. Gate Charge

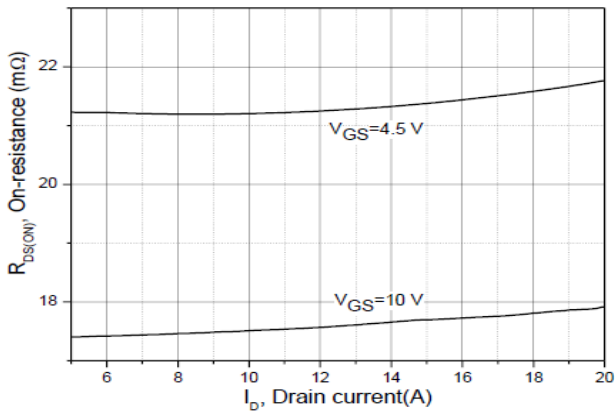

Figure5. Drain-Source on Resistance

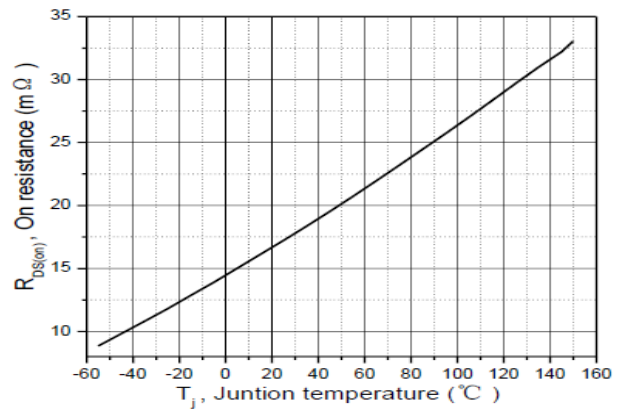

Figure6. Drain-Source on Resistance



YJD40G10A

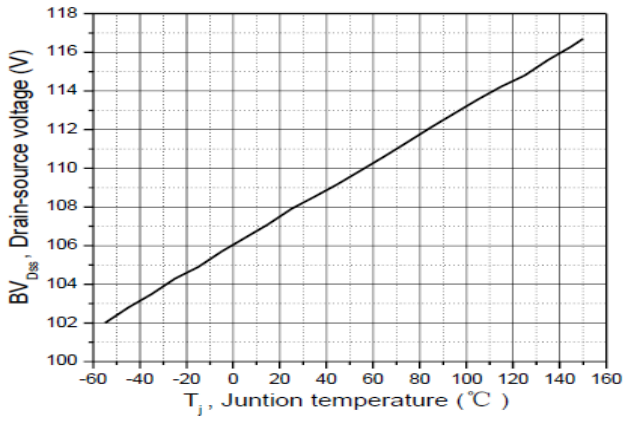

Figure7. Drain-source breakdown voltage

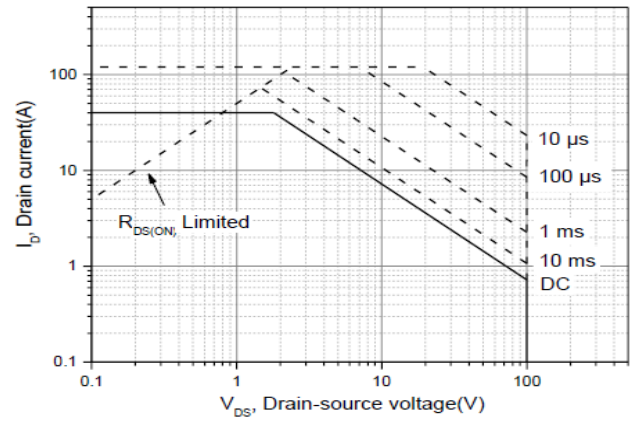
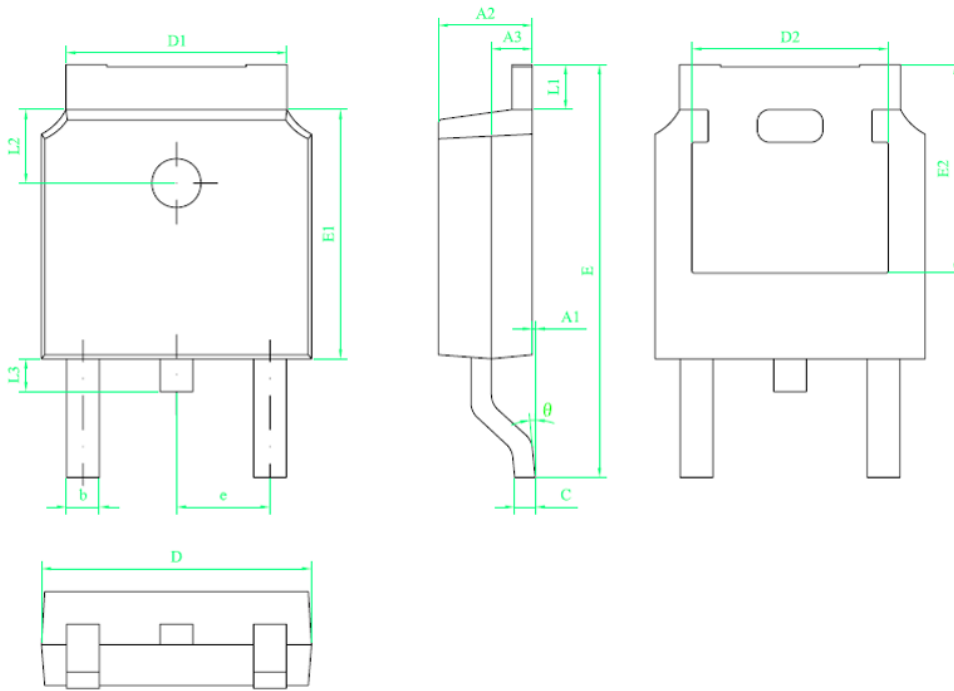

Figure8.Safe Operation Area



YJD40G10A

■ TO-252 Package information



符号	尺寸		
	min	nom	max
A1	0	---	0.10
A2	2.20	2.30	2.40
A3	0.90	1.00	1.10
b	0.75	---	0.85
c	0.50	---	0.60
D	6.50	6.60	6.70
D1	5.30	5.40	5.50
D2	4.70	4.80	4.90
E	9.90	10.10	10.30
E1	6.00	6.10	6.20
E2	5.20	5.30	5.40
e	2.20	2.286	2.40
L1	0.90	---	1.25
L2	1.70	1.80	1.90
L3	0.60	0.80	1.00
θ	0°	---	8°

技术要求:

1. 树脂体不应有崩裂、缺损等缺陷;
2. 树脂上下部X、Y方向偏差不得超过0.20;
3. 胶体两端留胶总和宽度不超过0.50;
4. 所有单位为mm;



YJD40G10A

Disclaimer

The information presented in this document is for reference only. Yangzhou Yangjie Electronic Technology Co., Ltd. reserves the right to make changes without notice for the specification of the products displayed herein to improve reliability, function or design or otherwise.

The product listed herein is designed to be used with ordinary electronic equipment or devices, and not designed to be used with equipment or devices which require high level of reliability and the malfunction of which would directly endanger human life (such as medical instruments, transportation equipment, aerospace machinery, nuclear-reactor controllers, fuel controllers and other safety devices), Yangjie or anyone on its behalf, assumes no responsibility or liability for any damages resulting from such improper use of sale.

This publication supersedes & replaces all information previously supplied. For additional information, please visit our website [http:// www.21yangjie.com](http://www.21yangjie.com) , or consult your nearest Yangjie's sales office for further assistance.